

TOWN OF GOSHEN, CT
 42A North Street Goshen, CT 06756
 860-491-2308 ext.232

Total Fee: 75.00

Draft

File no:	_____
Received:	_____
Approved:	_____
Denied:	_____
Fee Paid:	_____

**APPLICATION FOR INLAND WETLANDS
 AND WATERCOURSES PERMIT**

03/30/2024

Draft

Site Location 12 WYNWOOD COURT Assessors Map 06 Lot 086 00 Zone WL

Total Parcel Acreage _____ Total Area of Wetlands Disturbance _____

Owner of Record <u>LEITMAN I MICHAEL</u>	Tel: (H) <u>646-660-1609</u>	(W) <u>212-241-6694</u>
Mailing Address <u>PO BOX 1325 Roslyn Heights, NY 11577</u>		
Email Address <u>mleitman725@mac.com</u>		

Applicant <u>Michael Leitman</u>	Tel: (H) <u>646-660-1609</u>	(W) <u>212-241-6694</u>
Mailing Address <u>PO BOX 1325 Roslyn Heights, NY 11577</u>		
Email Address <u>mleitman725@mac.com</u>		

Agent/Lessee _____	Tel:(H) _____	(W) _____
Mailing Address _____		
Email Address _____		

To the Inland Wetlands and Watercourses Commission:

I, Michael leitman, hereby apply for an Inland Wetlands and Watercourses Permit, pursuant to Section(s) 404 of the Inland Wetlands and Watercourse Regulations for:

(describe proposed regulated activities)

Patio and unite pool

The undersigned hereby applies for an Inland Wetland and Watercourses Permit for the property described herein and confirms that:

- 1) He/She is familiar with the currently effective Inland Wetlands and Watercourse Regulations of the Town.
- 2) The statements and representation contained herein and in all supporting documents are true to the best of his/her knowledge.
- 3) By making this application, he/she gives permission to the Inland Wetlands and Watercourses Commission or its representative to enter the portions of the applicant's premises, which are the subject of this application for the purpose of inspection and investigation and otherwise evaluating the merits of the application.

LEITMAN I MICHAEL
 Signature of Owner

 Signature of Agent/Lessee

Michael Leitman
 Signature of Applicant

Nature and Purpose of Project: Building of unite pool and patio.

Applicant's Interest in Property: Owner

Is there a conservation or preservation easement on any part of this property? YES NO

Total Property Acreage: 1.36 Total Acreage of Development: 0.24

Total Acreage of Wetlands on Site: 0 Total Acreage Altered: 0.03

Total Acreage of Open Water Body on Site: adjacent Total Acreage Altered: 0

Total Linear Feet of Watercourses on Site: 150 Total Linear Feet Altered: 192

Total Buffer/Upland Review Area Altered: 100 ft

Total Area of Wetlands and/or Watercourses Restored, Enhanced, or Created:

Were there prudent and feasible alternatives to the proposed wetland, watercourse, and upland review area alterations?

YES NO

If yes, what were they? Only site for pool available with proper wetland and property line setback

If no, why not?

Is this property within 500 feet of a town line? YES NO

(If yes, the applicant must notify the adjacent municipal wetlands agency by certified mail, return receipt requested, on the same day of filing this application with the Inland Wetlands Commission/Land Use Office. Documentation of this notice shall be provided to the Commission.)

Does any portion of this proposed project fall within a Public Watershed Protection Zone (R-WP)?

YES NO

(If yes, the applicant must notify the Water Company by certified mail, return receipt requested, on the same day of filing this application with the Inland Wetlands Commission/Land Use Office. Documentation of this notice shall be provided to the Commission.)

APPLICATION TYPE:

Basic Application Permit Extension/Transfer Agent Determination

Declaratory Ruling Subdivision Lots After-the-Fact Activity

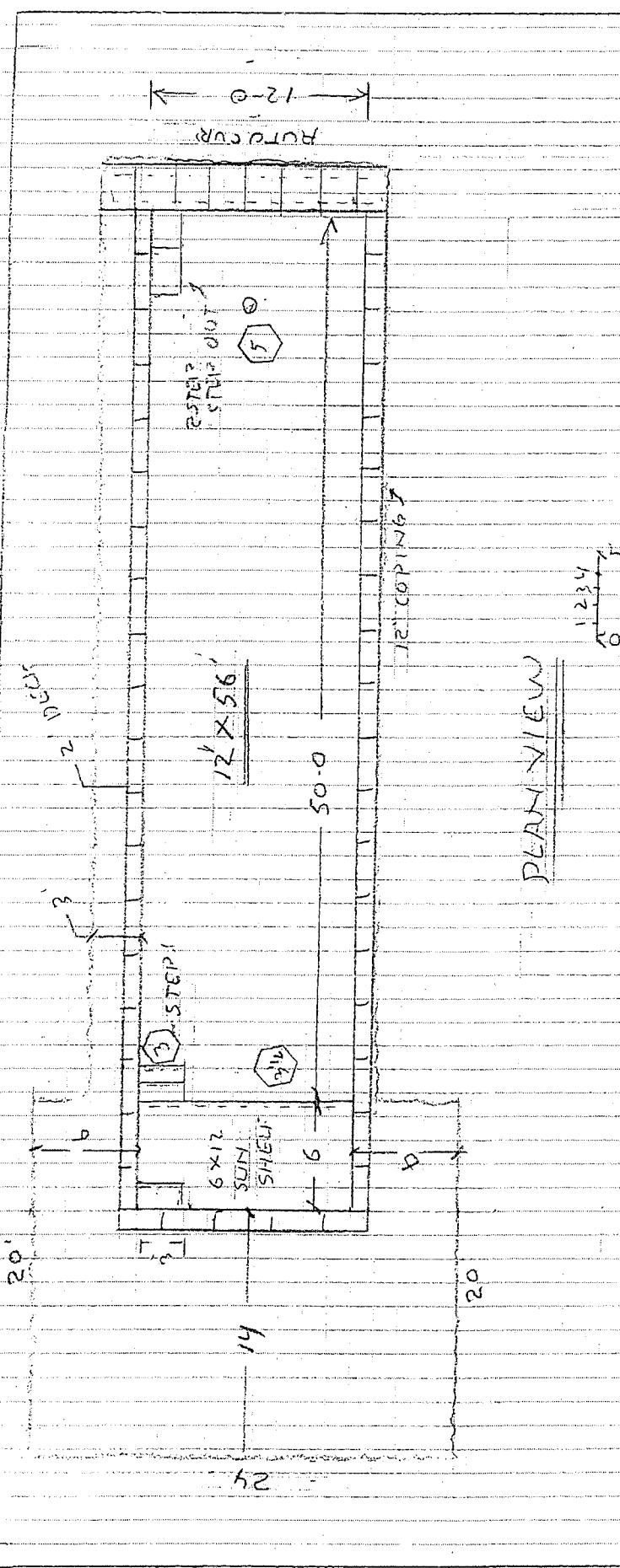

PLAN VIEW

SCOTT'S SCULPTURE & DESIGN A Custom Designed Plan For:	
LEITMAN 30 JHEN CT Eastchester Swimming Environment Since 1997 12 JAY 3-79-24 S12-1	